

# FUJI PIPELINE AND CABLE LOCATOR

## *PL-G*

Vibratory system and LED lighting up are newly equipped with PL-G and works just right above the pipe for making detection more clear.

One-handed operation with Keys and Receiver weighting only 1.8kg do not fatigue operators for many hours.

Measure data can be transferred into smartphone using the Bluetooth connection.



Instruments for the location of underground utilities and water leaks.

**FUJI TECOM INC.**

# FUJI PIPELINE AND CABLE LOCATOR

## PL-G



Receiver

Transmitter

Vibratory system and LED light are equipped with PL-G



### Vibratory and LED Lighting

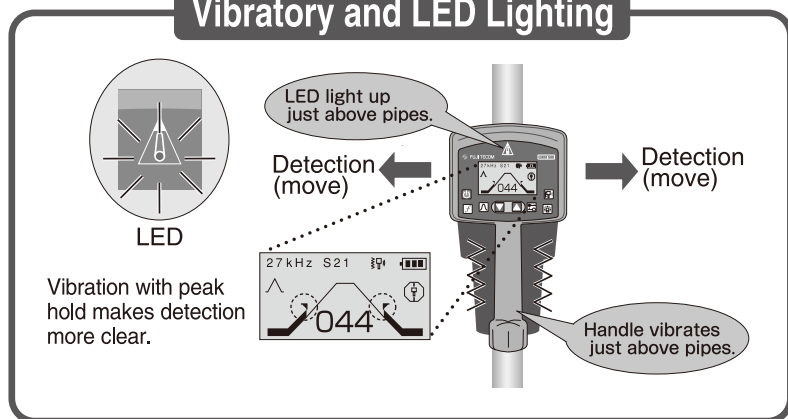

### Data Transfer into Smartphone

Measure data can be transferred to smartphones using app.

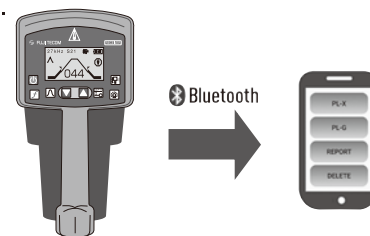

The works such as measure date, time and location can be saved for making operating reports.

### FEATURES

- Closest point of buried pipe just above shown more clearly. Point of buried pipe are indicate by vibration and light one.
  - Bluetooth is available on receiver and measurement data can be transfer to smartphone for making operating reports.\*
  - Transmitter automatically switch to "Direct Mode" when dedicated cable connected.
  - Impedance and phase display during loop-check for more surely performance.
- \* Bluetooth connection is only available by Android phones.

|              | Transmitter                | Receiver                   |
|--------------|----------------------------|----------------------------|
| Power Supply | D×4                        | AA×6                       |
| Size         | 288×241×105 mm             | 131×280×610 mm             |
| Weight       | 1.9kg (batteries excluded) | 1.8kg (batteries excluded) |

### SPECIFICATIONS

|                          |                                                                        |
|--------------------------|------------------------------------------------------------------------|
| Frequency                | : 8kHz, 27kHz, 83kHz                                                   |
| Transmitter output power | : Induction Mode : 0.5W<br>Direct Mode : 3W                            |
| Loop Check               | : Impedance : 1-10Ω<br>Phase Display : -179°-180°<br>Frequency : 512Hz |
| Detection Method         | : Maximum Method<br>Bar Method<br>Sonde                                |
| Depth Measurement method | : Traverse Method<br>Pull up Measurement                               |
| Depth Measurement Range  | : Pull up 0-5 m<br>Traverse 0-2 m                                      |
| Operation Temperature    | : -10 ~ +55°C                                                          |
| Wireless                 | : Bluetooth Ver.2.1 Class2 SPP Profile                                 |

The contents are subject to change without prior notice.



Instruments for the location of underground utilities and water leaks.

## FUJI TECOM INC.

**Head office** : 2-20, Kanda Sakuma-cho, Chiyoda-ku, Tokyo 101-0025, Japan  
TEL : +81-3-3862-3196 FAX : +81-3-3866-1979  
URL : <http://www.fujitecom.com/>  
E-Mail : [overseas\\_sales@fujitecom.co.jp](mailto:overseas_sales@fujitecom.co.jp)

**Branch office** : Sapporo, Sendai, Tokyo, Shinetsu, Nagoya, Osaka  
Hiroshima, Kyushu

**Technical development & training center** : Niiza

AGENT